

BIOWATER i Århus

- **EKSISTERENDE FORHOLD**, oversigtsplan
- **FORSLAG**, oversigtplan
- **DET NYE GADEKÆR**, planudsnit og snit
- **BEPLANTNING**, Frostfri zone, Lavvands zone og Oversvømmelses zone
- **VANDRENDER**, belægningen
- **DET NYE GADEKÆR**, indløbselement og bænk
- **RUMLIG MODEL**

EKSISTERENDE FORHOLD

Oversigtsplan

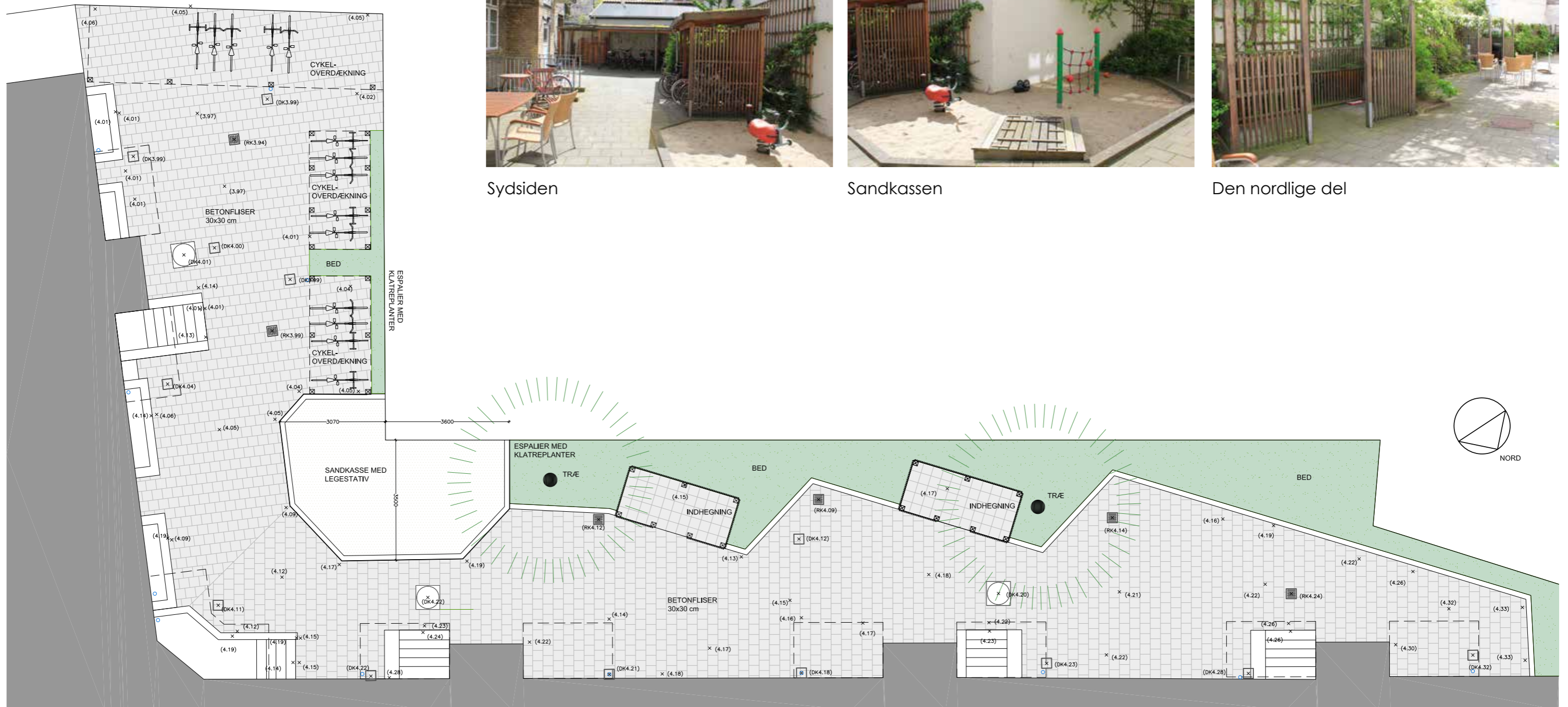

Sydsiden



Sandkassen



Den nordlige del

FORSLAG

Oversigtsplan

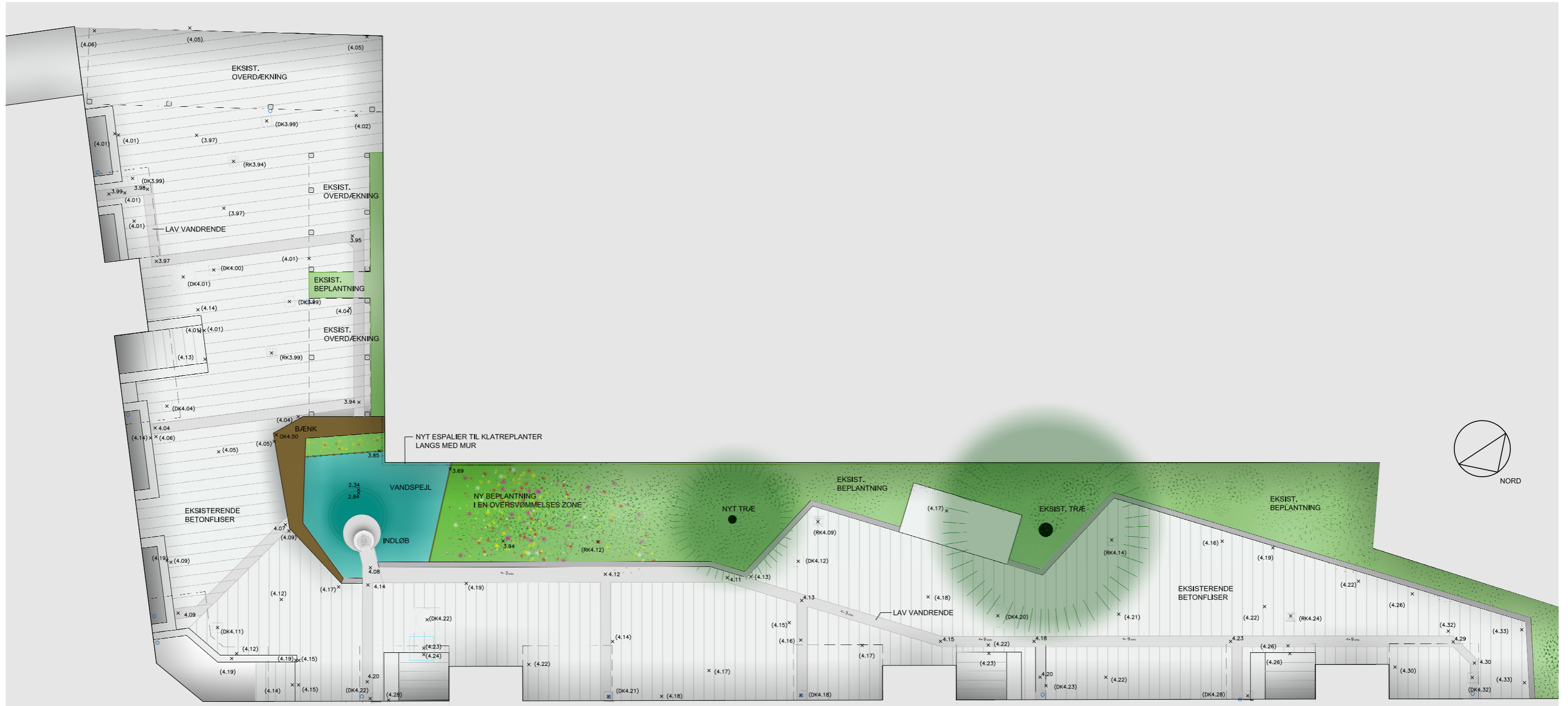

DET NYE GADEKÆR

med fast vandspejl og oversvømmelses zoner

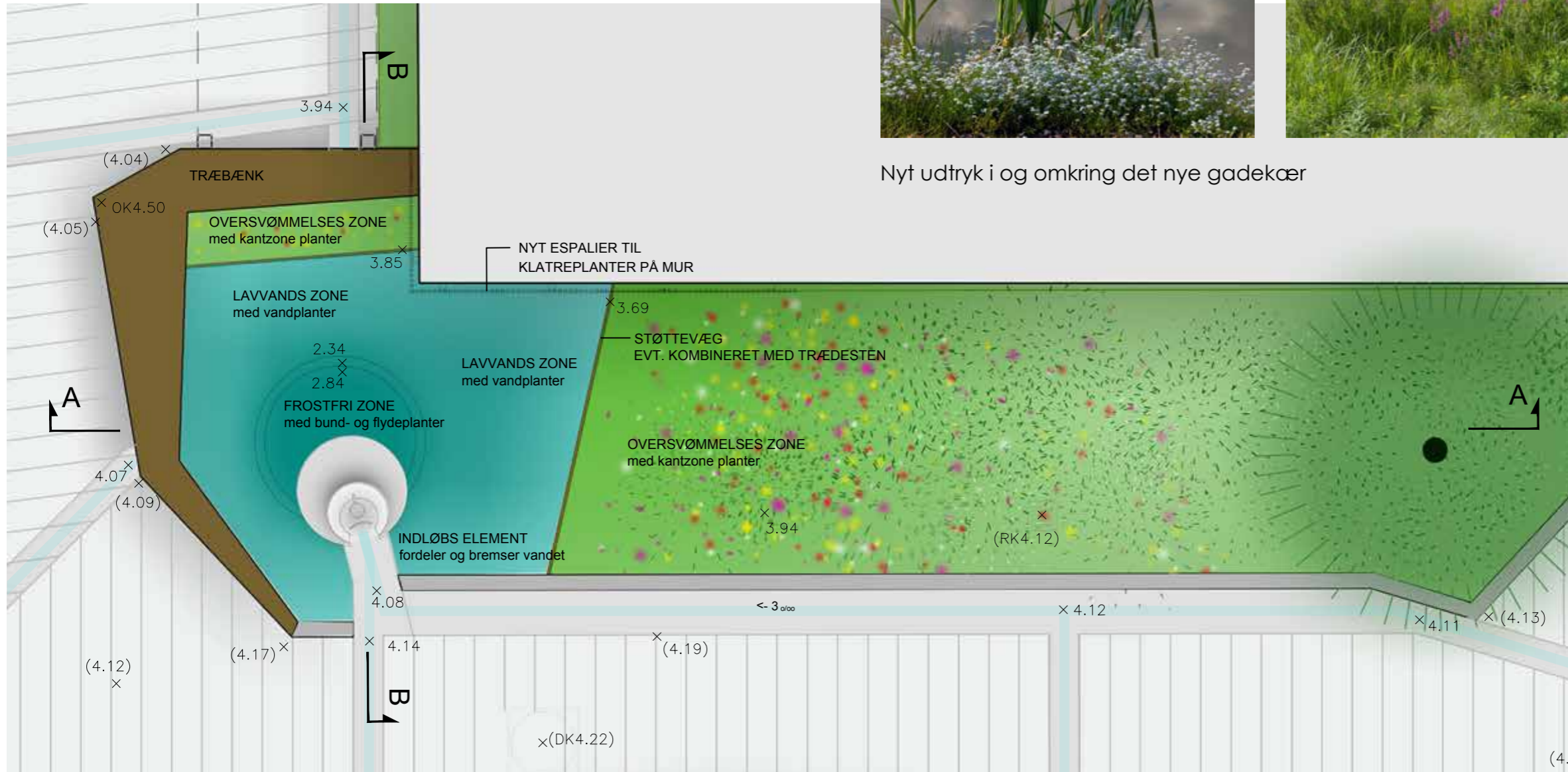

Nyt udtryk i og omkring det nye gadekær

DET NYE GADEKÆR

Snit / opstalt A

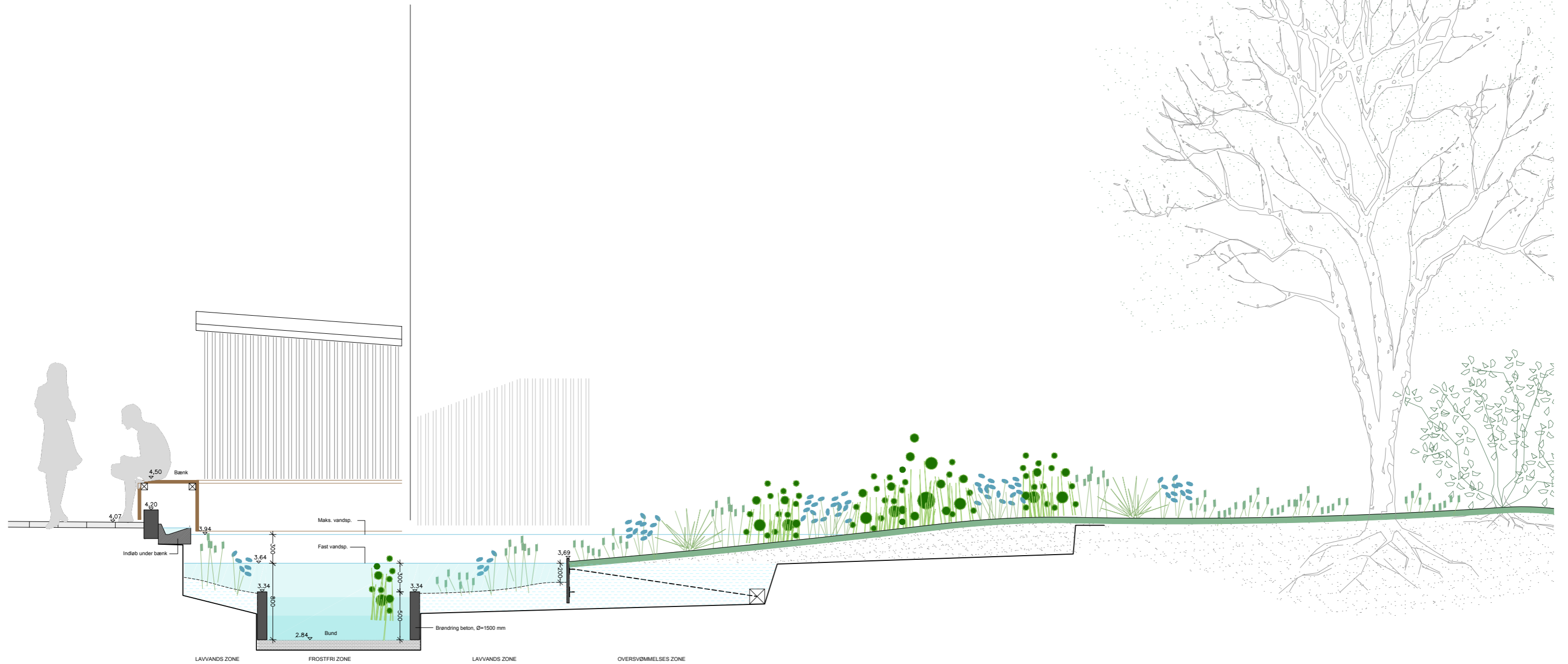

DET NYE GADEKÆR

Snit B

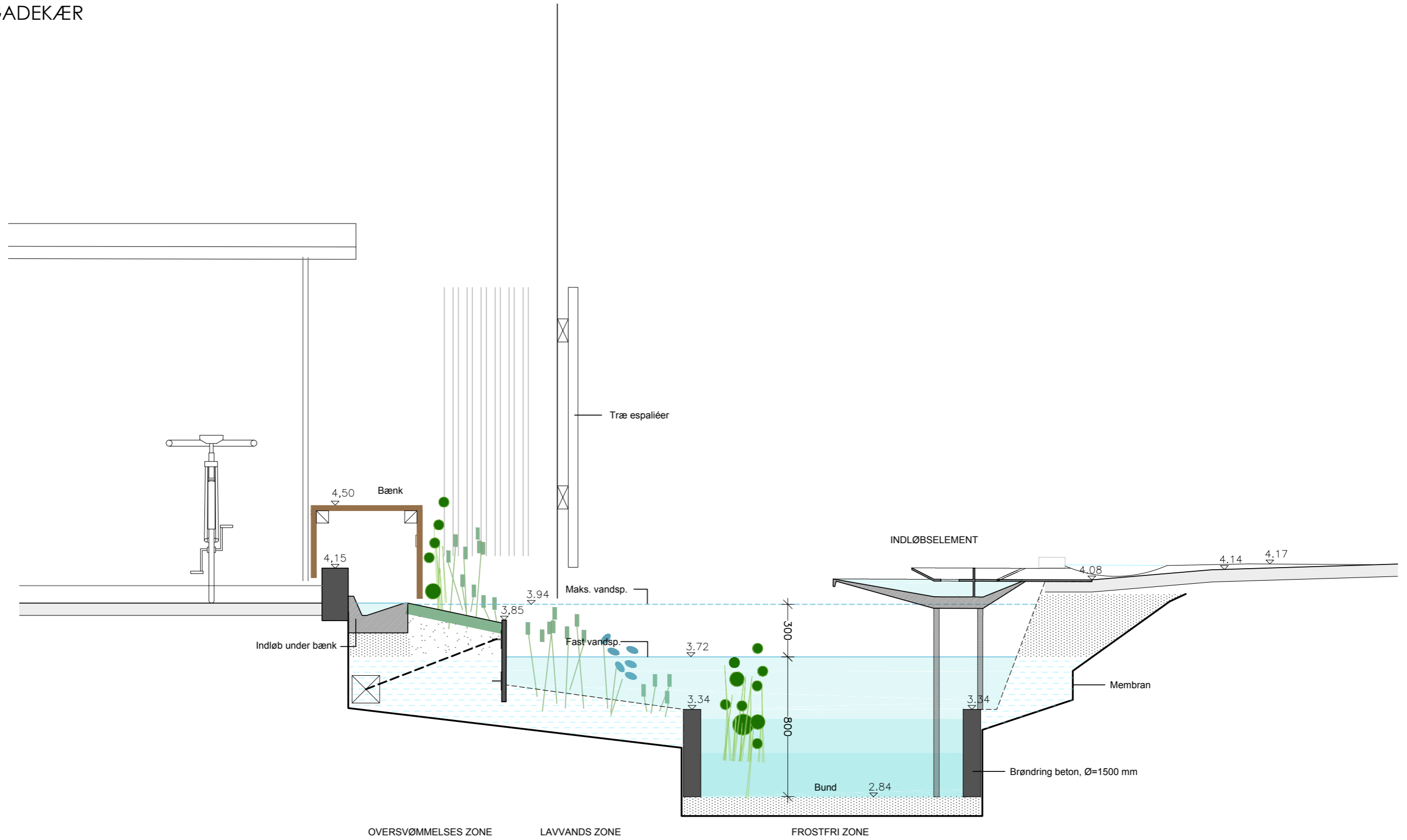

BEPLANTNING

Frostfri zone



Vandrøllike



Frøbid



Akstusindblad



Rustvandaks

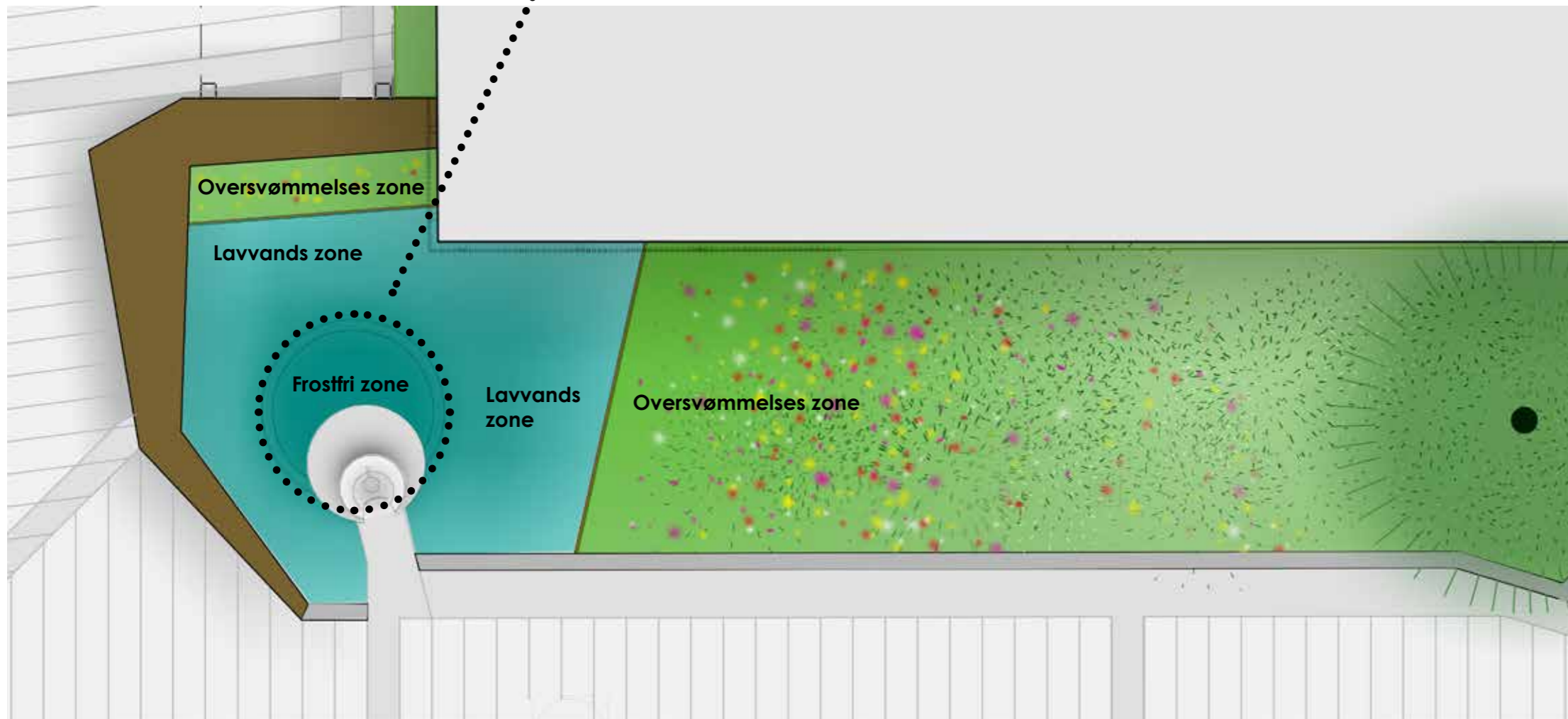

BEPLANTNING

Lavvands zoner



Gul iris



Kærmysse



Kattehale



Knippestar



Langbladet ranunkel

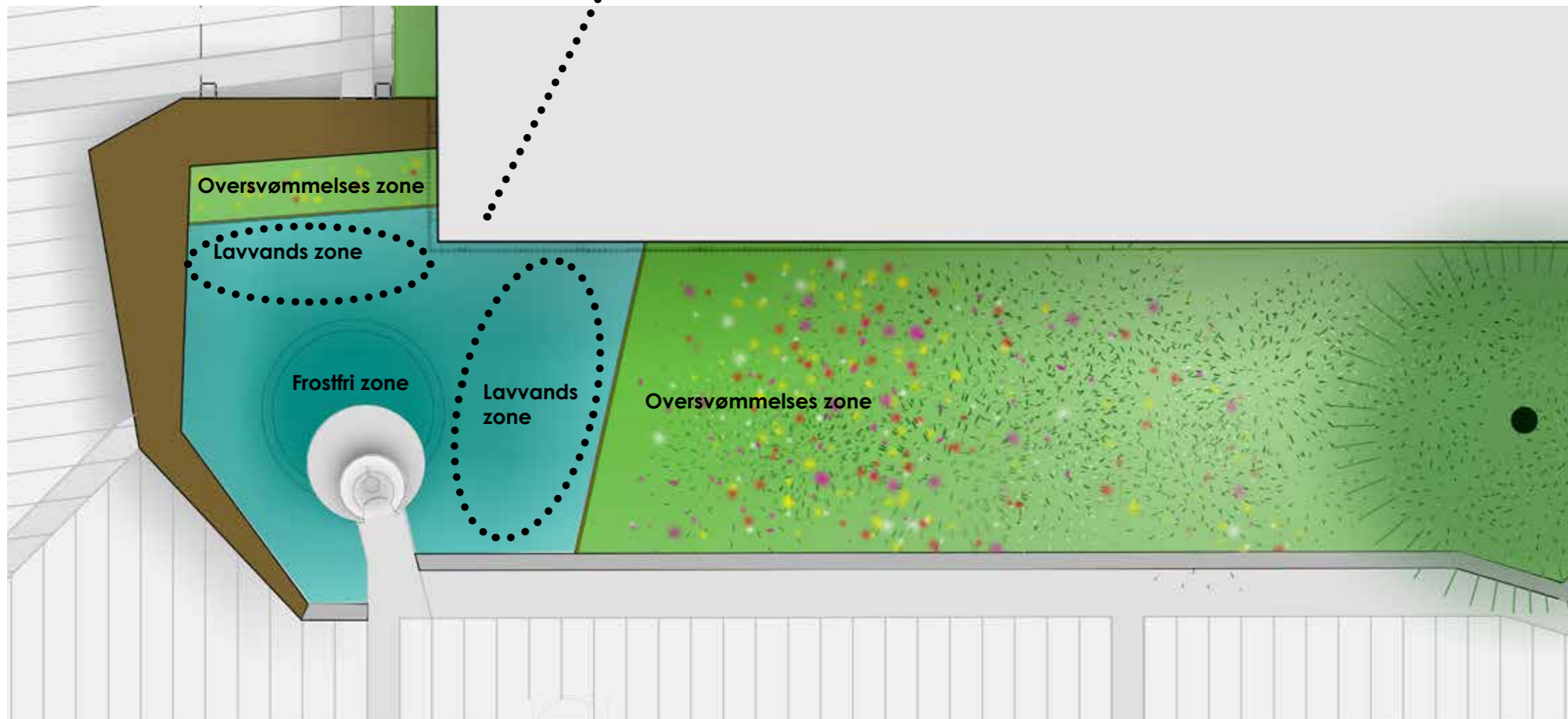

Vandpileurt



Alm. star



Næbstar

BEPLANTNING

Oversvømmelses zoner
- overvejende lave planter



Krybhvene
Mannasødgræs
5-10 cm



Engforglemmigej
10-50 cm



Alm. brunelle
5-25 cm



Brøndkarse



Pengebladet fredløs

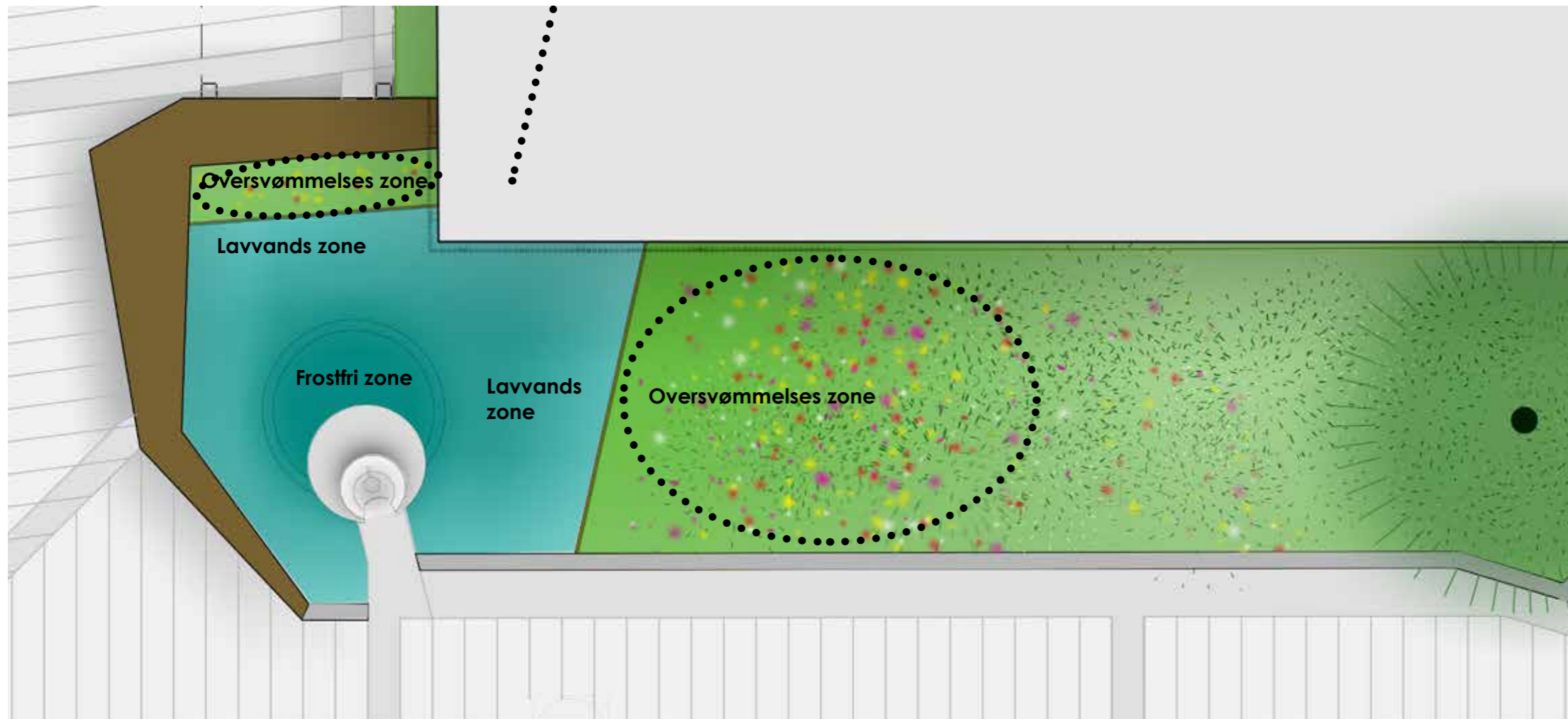

Engnellikerod
25-30 cm



Kærranunkel

BEPLANTNING

Oversvømmelses zoner
- overvejende høje planter



Dagpragtstjerne
20-60 cm



Slangeurt
20-80 cm



Kattehale
50-100 cm



Engstorkenæb
30-70 cm

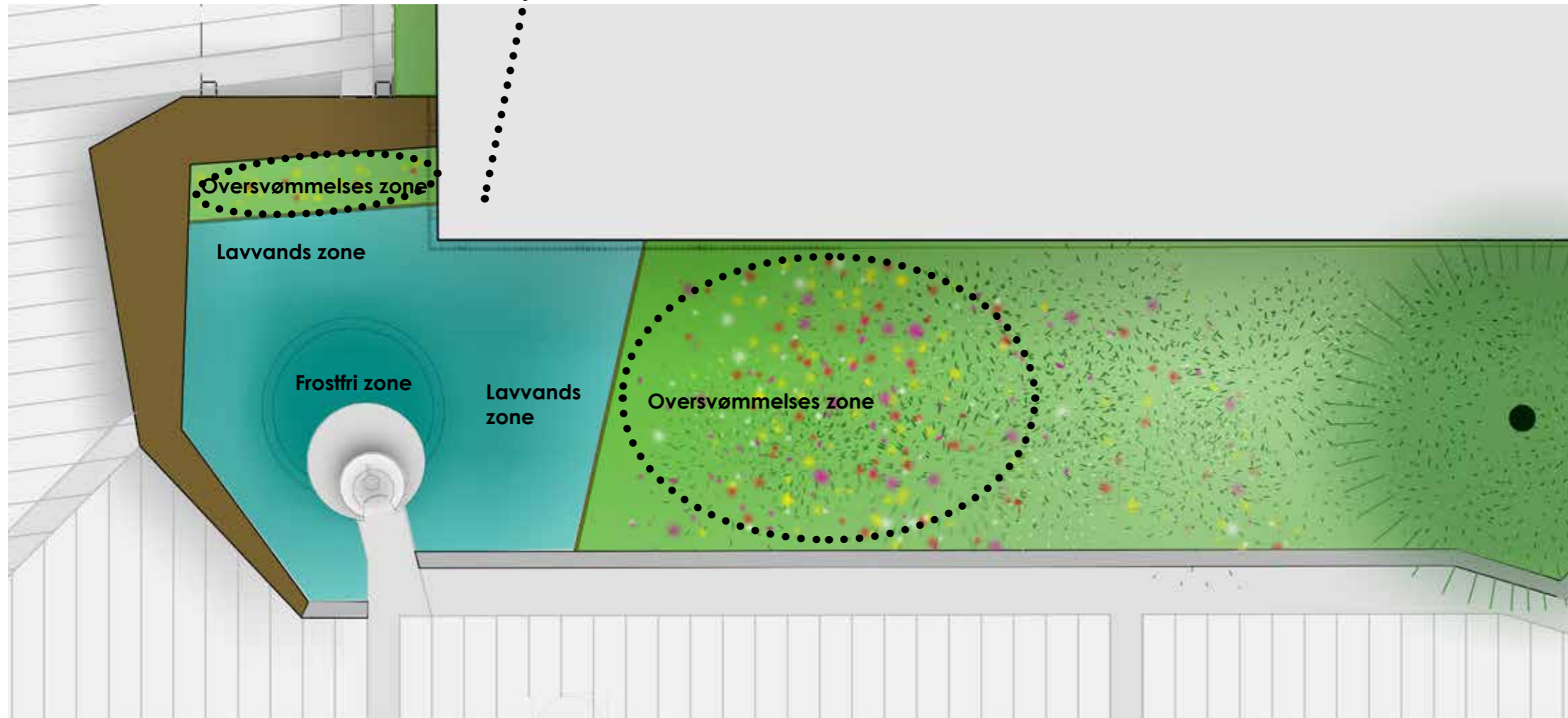

Alm. fredløs
50-80 cm



Gul iris
50-100 cm

VANDRENDER

Belægning

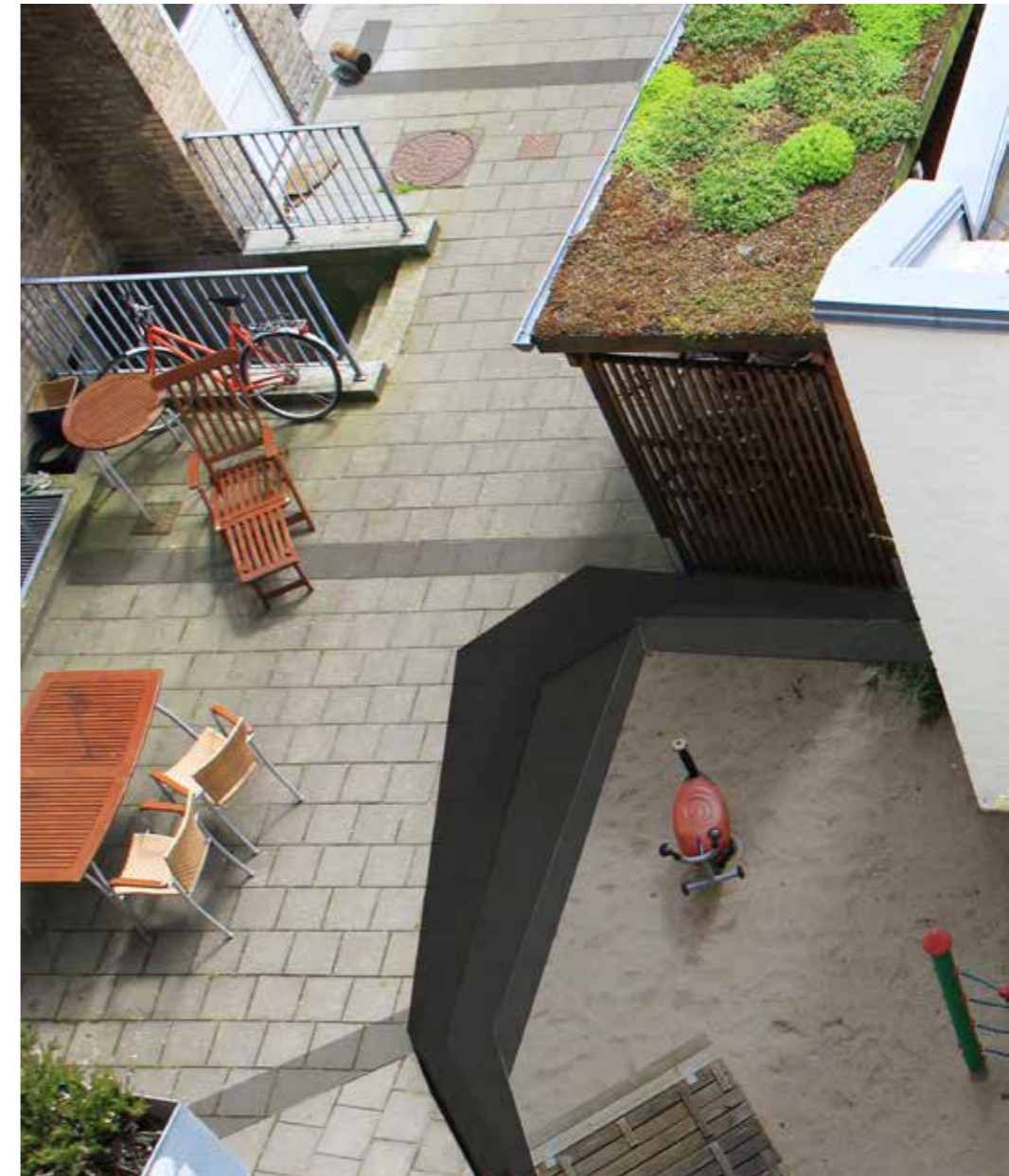
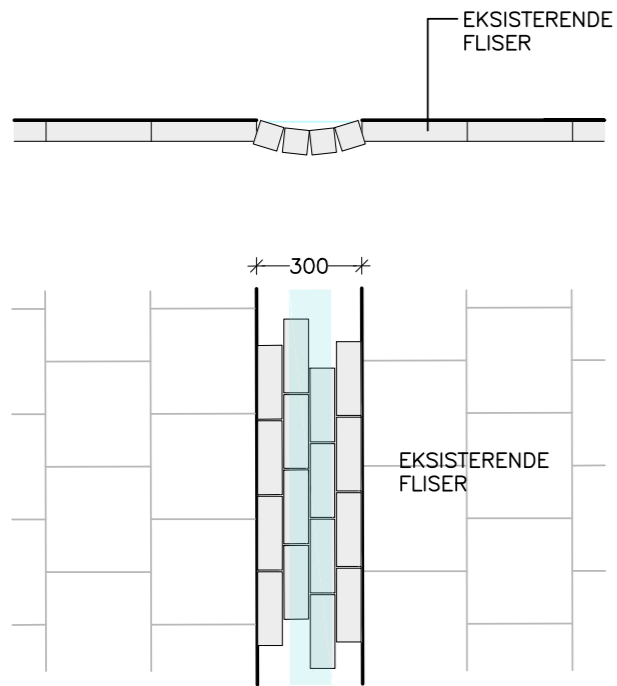

SF Kloster sten fra IBF
Dim. 71x71x210 mm

OBS! - Fugebredde bliver 5 mm

DET NYE GADEKÆR

Indløbselement og bænk

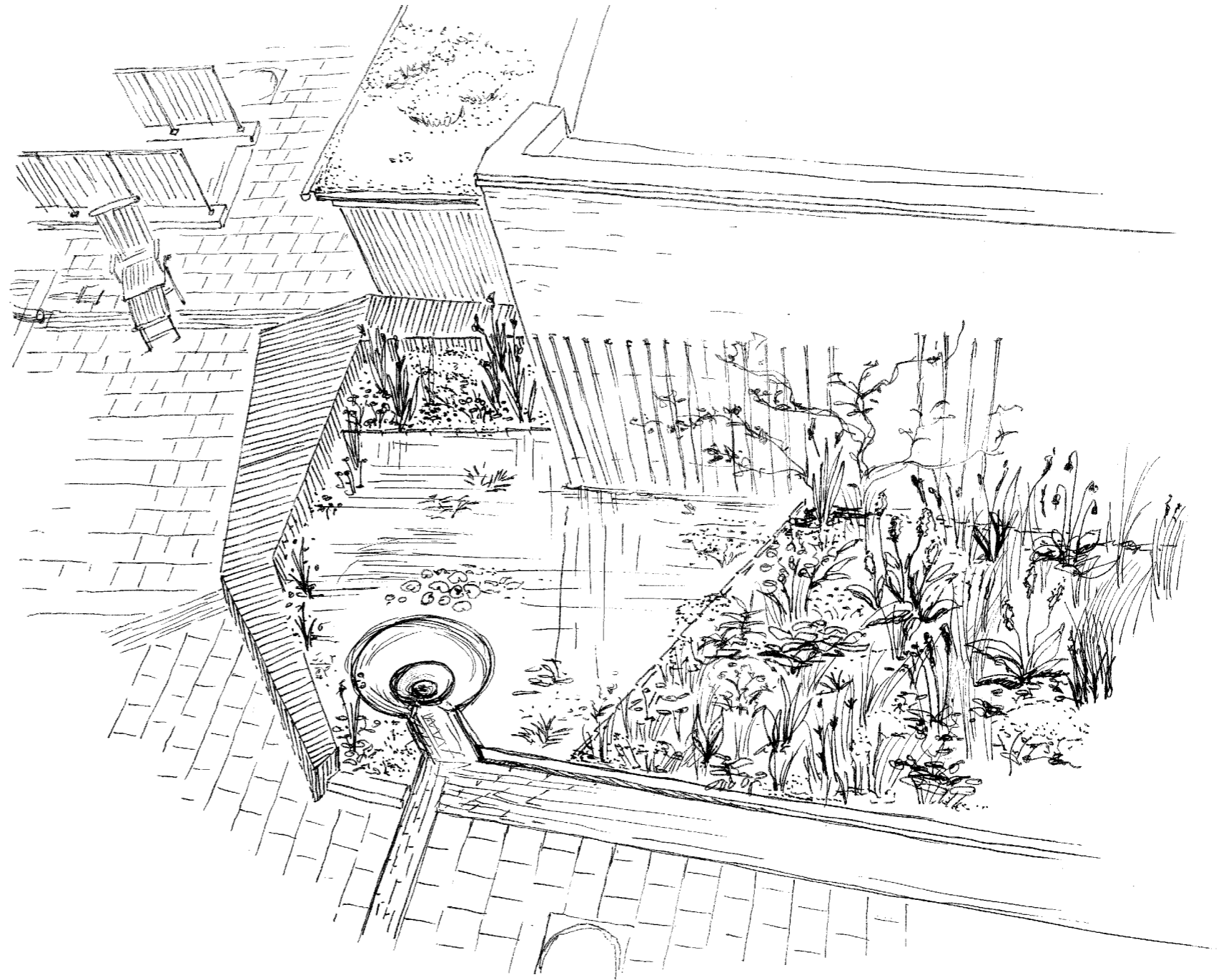
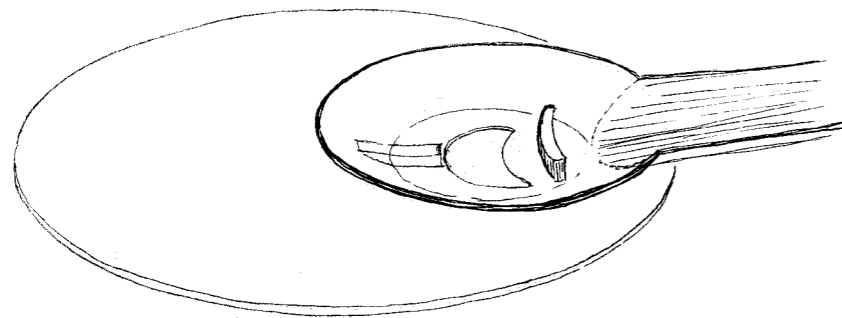

RUMLIG MODEL

Fugleperspektiv



RUMLIG MODEL

Fra altan i syd



RUMLIG MODEL

Fra hjørnealtan



RUMLIG MODEL

Permanent vandspejl

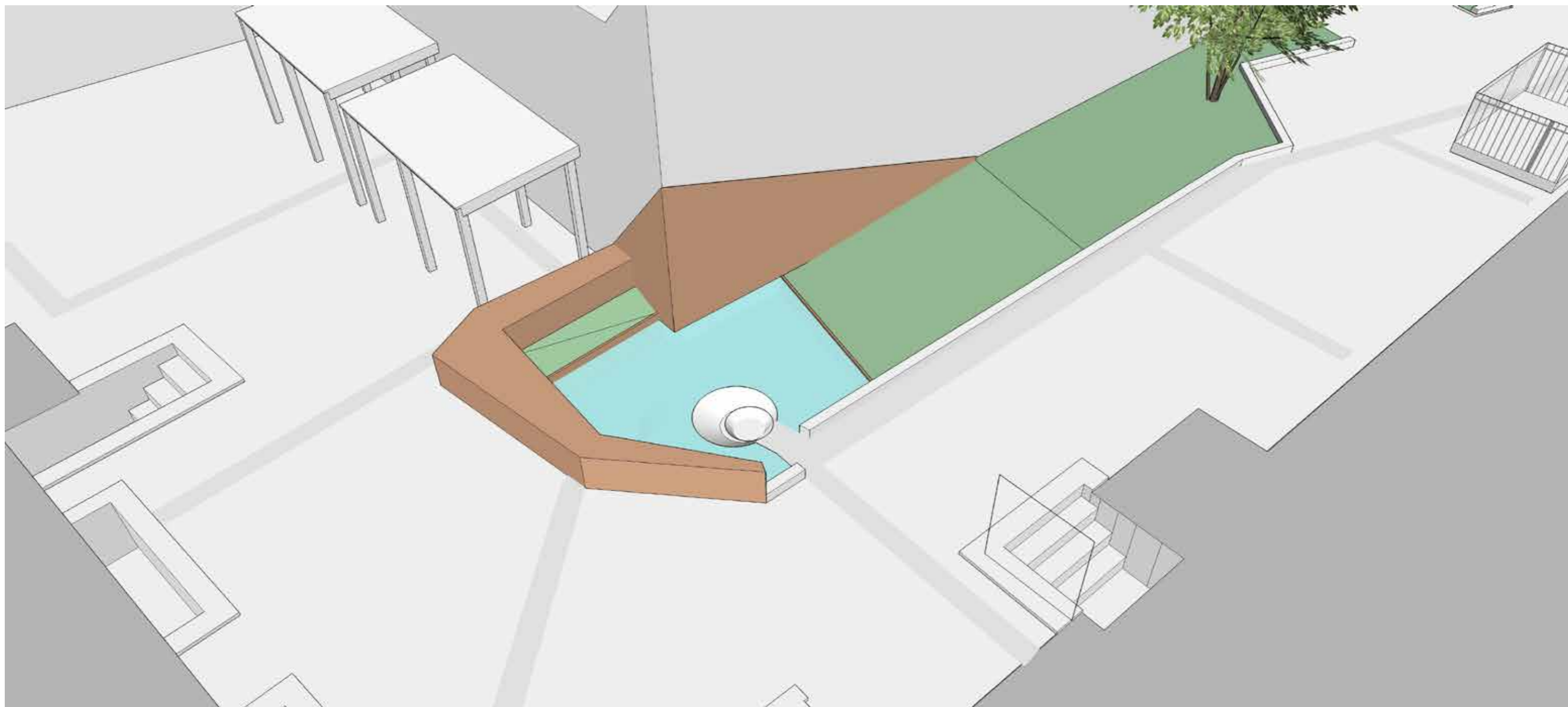

RUMLIG MODEL

Højt vandspejl

